

MSite Pod

Technical Specification

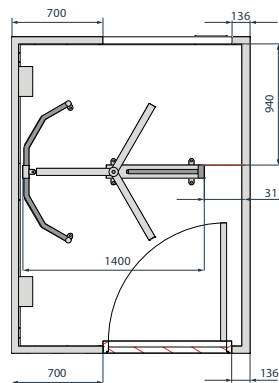

Plan view

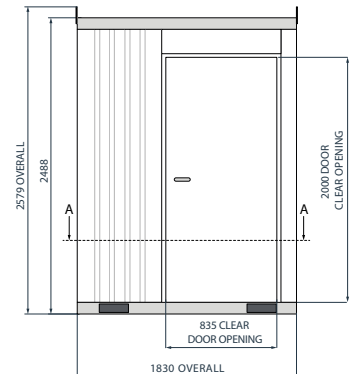

Front view

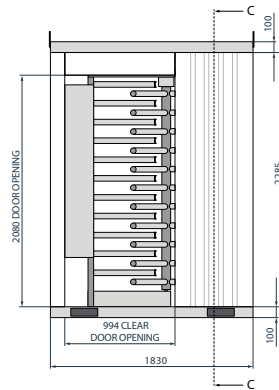

Rear view

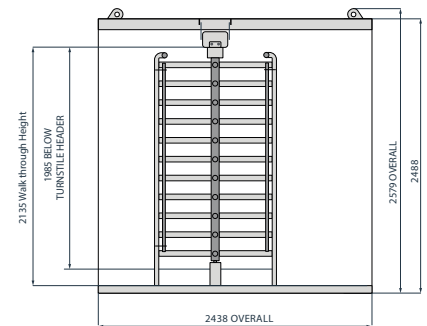

Side view elevation

Tolerance + or -5mm

Weight <1.5 Ton

Power Req 240v 32amp

Lifting Hiab via 4 Lugs

Required before installation

- Flat level hard core surface for Pod.
- Hiab access to Pod location with height of at least 8m (If less than 8m height available inform MSite).
- 32amp commando socket or 240v isolated fused spur at POD location.

Additional Information

All measurements in mm. Actual Pod specification may vary depending on each specific model.